

breezeYachting.swiss



# Curvelle QUARANTA

## Yacht For Sale



**EUR 6,950,000** VAT Exempt

# KEY FEATURES

- One-of-a-kind superyacht-catamaran build by a visionary owner
- 6 cabins for 12 guests, all on the main deck, with the unique concept of connecting doors
- RINA certified as a commercial vessel with unrestricted navigation
- Large volume of 298GT and a beam of 9 metres
- Fully submersible beach platform with a potential to carry 1000kg (5.5m tender)
- Has been honoured with 8 awards for her engineering, quality and design.



# SPECIFICATIONS

Manufacturer: **CURVELLE**

Model: **QUARANTA**

Flag: **Marshall Islands**

Length: **34.1 m / 111 ft 6 in**

Draft: **2.45m (@ full load)**

Beam: **9 m / 29 ft 6 in**

Displacement: **165 t**

Gross Tonnage: **298 t**

Year built: **2013**

Classification: **RINA + MCA Commercial yacht**

Hull / Superstructure: **Carbon/E-glass Hybrid Epoxy**

Designer: **Lila Lou**

Tenders & toys: **2017 Williams 520**

Main Engines: **2 x 1900 HP Caterpillar C32 ACERT**

Engine Hours: **± 1845 (May 2023)**

Generators: **2 x 50 kw @ 50Hz ONAN (John Deere)**

Generator Hours: **± 7500 (May 2023)**

Cruising Speed: **12 kn**

Max Speed: **18 kn**

Max Range: **2200 nm (@ 9 knots)**

Fuel Capacity: **22,000 liters**

Fresh Water Capacity: **3,800 liters**

Black Water: **4,000 liters**

Guests: **12**

Crew: **6**

Cabins: **6**

breezeYachting.swiss



# WINNER OF 8 AWARDS



reddot award 2014  
winner

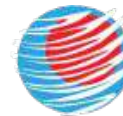

**KOMPOZİT SANAYİCİLERİ DERNEĞİ**  
TURKISH COMPOSITES MANUFACTURERS ASSOCIATION

breezeYachting.swiss





**quaranta**  
BIKINI

breezeYachting swiss





breezeYachting.swiss





quaranta

CASTLETOWN

breezeYachting swiss





This door  
won't be  
open unless  
it's OK

breezeYachting.swiss





breezeYachting.swiss





breezeYachting .swiss





breezeYachting swiss





breezeYachting swiss







breezeYachting.swiss





breezeYachting.swiss





breezeYachting.swiss





breezeYachting swiss





breezeYachting.swiss









breezeYachting swiss





breezeYachting swiss





breezeYachting swiss





breezeYachting swiss





breezeYachting swiss





breezeYachting swiss





breezeYachting.swiss











breezeYachting.swiss





breezeYachting.swiss







breezeYachting.swiss





breezeYachting.swiss





breezeYachting.swiss





This door  
must be  
kept closed  
at sea



# MACHINERY

## Main Machinery

Main Engines: 2 x 1900 HP Caterpillar C32 ACERT  
Engine Hours: Port 1845 hrs, Starboard 1845 hrs (May 2023)  
Gear Boxes: ZF 3050A, with trolling and trailing valves

## Generators & Electricity

Generators: 2 x 50 kw @ 50Hz ONAN (John Deere)  
Generator Hours: ±7500 hrs (May 2023)  
Electricity on board: 400V/230V 50 Hz  
Batteries: 4 banks of batteries, 24 Volts

## Auxiliary Machinery

Steering System: DATA hydraulic NFU & FFU  
Bow Thruster: 2 x DATA 40 HP Sidepower Units  
Stabilizers: NAIAD Full RCS (Ride Control System) with 2  
Trim Tabs & 2 T-Foils

## Fuel & Oil System

Fuel Filters: Alfa Laval  
Fuel Pumps: Gianneschi  
Sewage Treatment Plant: Tecnicomar ECOMAR 16

## Fresh Water System

Fresh Water Makers: 2 x Idromar MC4 Duplex , 250 Litres each  
Fresh Water Filters, Heater and Pump: Gianneschi

## AC & Ventilation System

Air Conditioning:

- Heinen & Hopman, 200,000 BTUs
- Ventilation system takes fresh air
- Central chillers have reversible system for heating

Air Compressor: 1 x Atlas Copco

## Deck Machinery & Equipment

Anchor: 2 x SHHP Ultra Anchor 316 stainless steel  
Anchor Chains: 2 x 120m, 16mm Grade 2  
Davits: DATA 250 kg lifting capacity, 6 fixing points throughout the yacht  
Gangway: Sanguineti Chiavari  
Winches: Electric  
Aft hydraulic swim platform: DATA 1000 kg lifting capacity



# EQUIPMENT

## Navigation Systems

Radar: 2 x Sperry Marine Vision Master with Hatteland Display  
Gyrocompass: Sperry Marine  
Auto Pilot: NAVIPILOT 4000  
DGPS: 2 x SAAB GPS Navigator  
GMDSS: McMurdo  
NAVTEX: McMurdo  
Speed log: Sperry marine 0098-11  
Depth Sounder: ELAC LAZ 5100  
Plotter: Jeppesen  
Wind-Speed Log: Sailor

## Security Equipment

Satellite: ESAT  
INMARSAT: Sailor  
VHF: 3 x Sailor VHF  
SART: McMurdo  
EPIRB: 2 x Sailor  
AIS: EasyView

## Entertainment, AV and IT Systems

Audio Equipment: Ceiling speakers on all decks  
Video Equipment: Samsung TVs with ROKU boxes  
AV system: Control 4 with Ipad and ROKU boxes

## Safety, Fire and Security Equipment

Alarm System: Consilium  
CCTV System: Chrisv  
Cameras: 6 x ER Cameras  
Monitors: 2 (wheelhouse and crew mess)  
Fire Extinguishers: 27 pax  
Fire Suppression: Consilium  
Fire Pumps: 2 x Gianneschi ACB 531/B (1 per ER)  
Life Rafts: 2 x Zodiac 20 pax - expiration in 2033  
Life Rings: 4  
EPIRBS: 2 x Sailor  
Flares: 16  
Life jackets: 31  
Medical boxes: 3 boxes

## Galley Equipment

Dump waiter: Serving 2 decks - upper salon and sundeck  
Stove: Siemens 5 burners  
Oven: Bosch (big), Siemens (small)  
Microwave Oven: Siemens  
Refrigerator: 2 x Electrolux  
Freezer: 2 x Electrolux  
Ice Maker: 3 x Electrolux  
Hood: Commercial grade  
Dishwasher: Siemens  
Washing Machine: 2 x Miele Washer  
Dryer: 2 x Miele Dryer  
Trash Compactor: Broan

breezeYachting.swiss



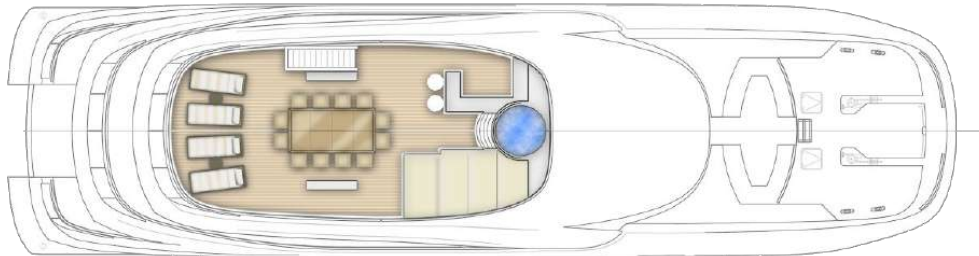
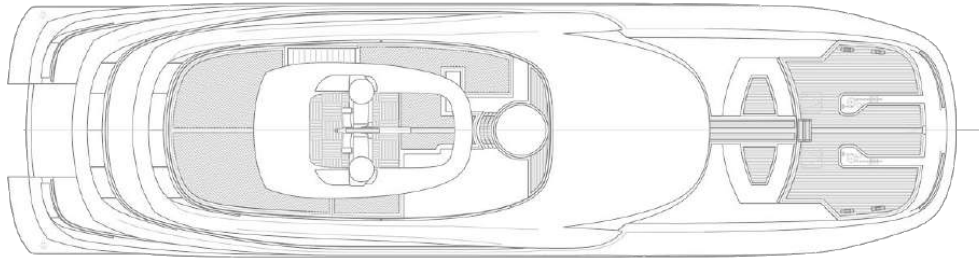
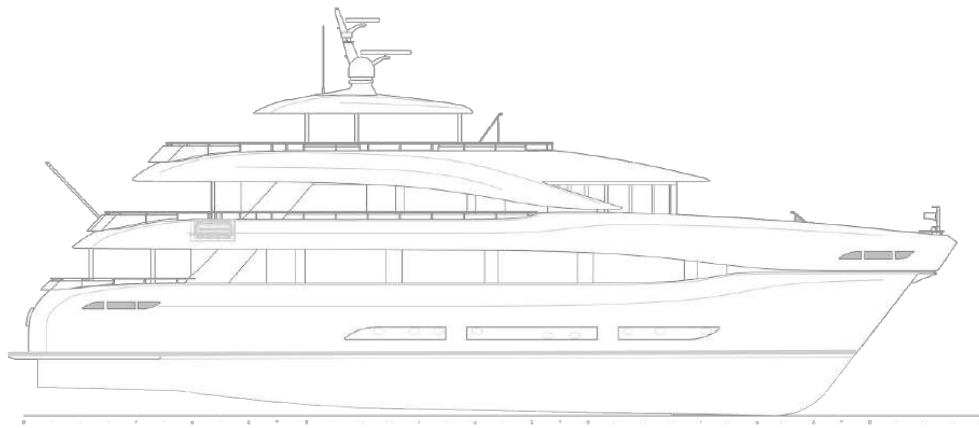

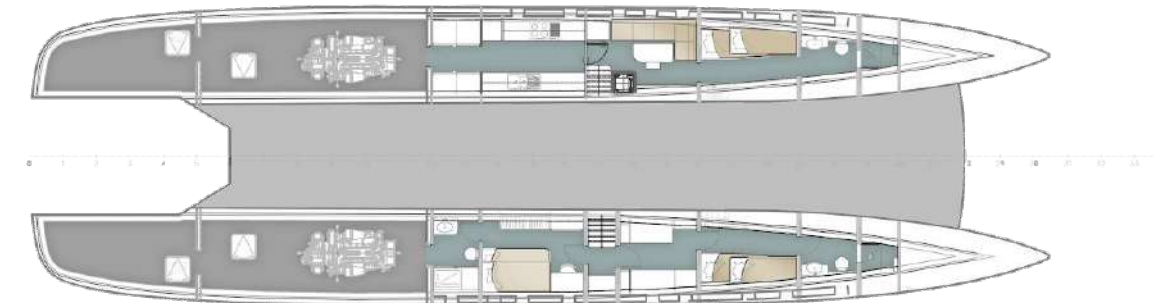
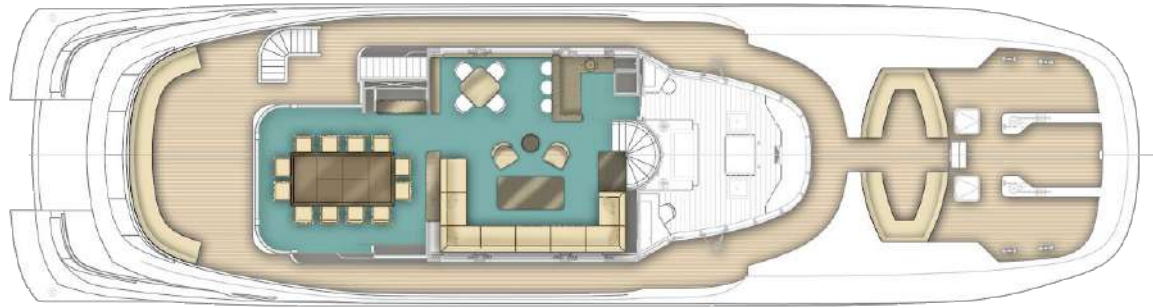



[For more information, CLICK HERE](#)

[For virtual tour, CLICK HERE](#)

breezeYachting swiss





**EMMA KARANOVA**

Yacht Advisor

 WHATSAPP ME

m. +34 622 128 338

[emma@breezeyachting.swiss](mailto:emma@breezeyachting.swiss)

# breezeYachting.swiss

WE SPEAK YACHTING. LET'S TALK.



Switzerland · Malta · Spain · Monaco

[www.breezeYachting.swiss](http://www.breezeYachting.swiss)



DISCLAIMER

The company offers the details of this vessel in good faith but cannot guarantee or warrant the accuracy of this information nor warrant the condition of the vessel. A buyer should instruct his agents, or his surveyors, to investigate such details as the buyer desires validated. This vessel is offered subject to prior sale, price change or withdrawal without notice.