

breezeYachting.swiss



**Kaiserwerft Baron 102**

‘SEA BREEZE ONE’

EUR 2'300'000 VAT paid | 31m | 2004

# KEY POINTS

- Master cabin on the main deck
- German built to the highest standards
- Stabilised with seakeeper m26
- New Navigation & Communication equipment from 2020
- Lots of interior space, high ceilings
- Unusual layout: raised dining area and pilot house
- 50% share can be bought





breezeYachting.swiss







breezeYachting.swiss















breezeYachting swiss





breezeYachting swiss













# SPECIFICATIONS

<b>Builder:</b>	Kaiserwerft
<b>Model:</b>	Baron 102
<b>Year:</b>	2004
<b>Hull/Superstructure:</b>	GRP / GRP
<b>Deck material:</b>	Teak
<b>Interior Designer:</b>	Kirschstein Designs
<b>Naval Architect:</b>	KaiserWerft GmbH
<b>Length overall:</b>	31.0m (101' 8")
<b>Beam:</b>	6.81m (22' 4")
<b>Draft:</b>	3.10m (10' 2")
<b>Gross tonnage:</b>	155 tons
<b>Displacement:</b>	96 metric tons
<b>Net tonnage:</b>	46 tons
<b>Guests:</b>	8
<b>Staterooms:</b>	4
<b>Configuration:</b>	3 double, 1 twin
<b>Crew:</b>	4
<b>Engines:</b>	2 x MTU M91 2000 16V 2350rpm
<b>Engine hours</b>	port 4946 / starboard 7270 (18.07.2023)
<b>Generators:</b>	2 x 60KW HFL Marine Generators
<b>Generators Hours:</b>	port 12469 / starboard 12719 (18.07.2023)
<b>Stabilizer:</b>	Seakeeper M26
<b>Cruising Speed:</b>	15.0 knots
<b>Maximum Speed:</b>	20.0 knots
<b>Consumption @ 12 knots:</b>	300.00 (L/HR)
<b>Range (nm):</b>	550nm
<b>Fuel:</b>	14,000 l
<b>Fresh water:</b>	2,000 l
<b>Gray water:</b>	1,200 l
<b>Black water</b>	800 l
<b>Lube Oil:</b>	450 l



# EQUIPMENT

## Auxiliary Equipment

Steering system BCS twin hydraulic ram, twin balanced rudder arrangement with interlink.

Bow Thruster 36 kW/50 hp, Hyd. powered via PTO

Stern Thruster 36 kW/50 hp Hyd. powered via PTO

Fuel Filters Racor D-75/1000MAX Racor D-\*500MAM30

Fire/Bilge Pump 1 x Biergans AM 50EM2 T50, 40m<sup>3</sup>/hr 400VAC, 1 x ACM 401BT, 24VDC, 14m<sup>3</sup>/hr 4xJabsco 3550

Boiler 2 x G&R, 200 litre Electric Hot Water Boiler 5+5kw

WC's 6 x TECMA Marine WCs, sea water flush plus integral Water bidet

Air Conditioning DOMETIC

Water maker AQUABASE, 200l per hour

Stabiliser Seakeeper M26

## Electrical

Generators 2 x HFL Marine Generators, 3 phase, 230/400 volts AC 50 Hz/(60 kW)

Electricity 230 volts AC 1 phase 50 Hz, 400 volts AC 3 phase 50 Hz

Shore power ATLAS

Power Convertor Output 80 kVA, 180520 VAC 5060 Hz, mono or 3 phase w/ synchronisation, dual shorecord

Batteries with Dolphin chargers - 2pcs (120A 3pole):

- 800Ah 24V Domestic

- 400Ah 24V Engine Starting

- 200Ah 12V Radio/Coms

- 200Ah 12V Service

Inverter Mastervolt 24V to120V

## Communication & Navigation

Magnetic Compass 1 x Cassens Plath mainhelm

Sat. Compass 1 x Simrad HS50

Auto Pilot Simrad AP50 Hand remote, heading signal from Simrad HS50 and Rategyro/Fluxgate RFC35R

Depth Sounder

Forward looking sonar FLS Gold

Radar Simrad RA83 Single 4' Scanner

GPS signals from Simrad HS50 & Simrad GN335/W

Weather Fax Navtex NAV-5

3 x NSOevo3S SIMRAD Chartplotters

Wind Inst. Simrad IS 15 with lot/log

- Echosounder SIMRAD S3009

- VHF radio

- Sea Tel Marine Satellite

## Office equipment

Network 2x patchfeld switch HP procurve 2124

Printer Network Brother MFC 9030 printer/fax/copy

Internet Connection with the Simrad F55 System

Facsimile Interfaced via PABX to SATCOM, GSM & PSTN

breezeYachting.swiss



## Domestic appliances & laundry

### Main galley:

Miele 4 ring cooking stove  
Miele Air Extractor Hood  
Candy Oven  
Miele Microwave  
Miele Steam cooker  
Freezer  
Refrigerator  
Miele Coffee Machine  
Universal Trash Compactor  
Miele Dish warmer  
Liebherr Wine cooler

### Crew mess:

Siemens Microwave  
Siemens Refrigerator  
Siemens Cooking stove  
Siemens Air Extract Hood  
AEG Freezer

### Laundry:

Miele Washing machine  
Miele Dryer

### Guest area:

Miele Refrigerator

### Helm station:

Coolmatic Refrigerator

### Owner's Cabins

Coolmatic Refrigerator  
Salon Icemaker  
Miele Refrigerator  
Liebherr Refrigerator

## Deck

Anchor windlass 2x 3500 watt/24 volt  
Capstans Lofrans 2x1500watt/24VDC  
Ground Tackle Anchor 2 x 128 kg, High Holding Power  
Chain 2x 110 metres, 12,5mm stud link  
Boat Crane: Besenzoni Hydraulic Crane, type G 309 600 kg  
Passerelle: Besenzoni Hydraulic Passerelle Type PI 383

## Tender

5m Tender 50hp Yamaha (6 person including crew)



# ENTERTAINMENT

## Audio Visual Systems

Salon	Beo-Sound 9000 Audio/Hif BeoCord V8000 video recorder B&O DVD player BeoVision 4-42 TV Karthrein Sat receiver UFD590 Sonance Ceiling speaker
Owner's suite, main deck	BeoCenter2 audio/HiFi BeoVision 5 TV HT 502 speakers Karthrein Sat receiver UFD590
VIP cabin, Lower deck	BeoVision 5 TV Lower deck HT 502 speakers Karthrein Sat receiver UFD590
Guest cabins	BeoVision 6 TV Center 2 audio/HiFi HT 502 speakers Karthrein Sat receiver UFD590
Crew cabins & mess	2x Sharp LC-15S1E TV 2x Car radio Karthrein Sat receiver UFD590
Dining area	BeoVision 6 TV
Galley	Car radio
Aft deck & boat deck	Ceiling Speaker



# LAYOUTS

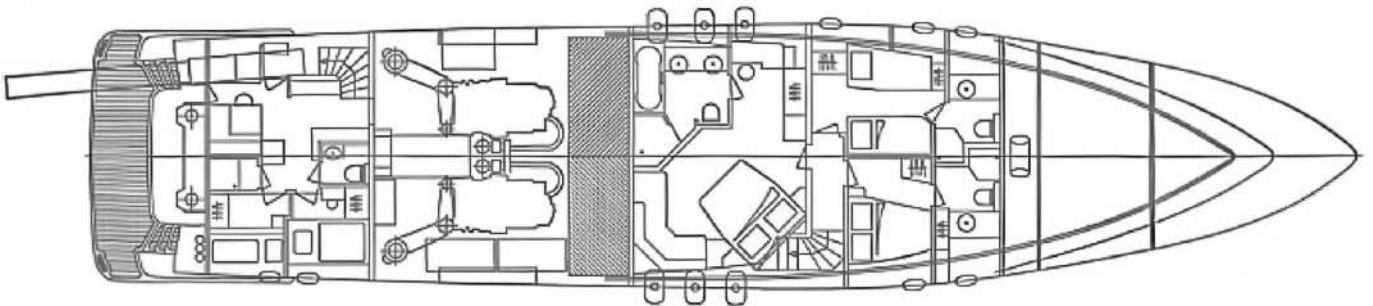
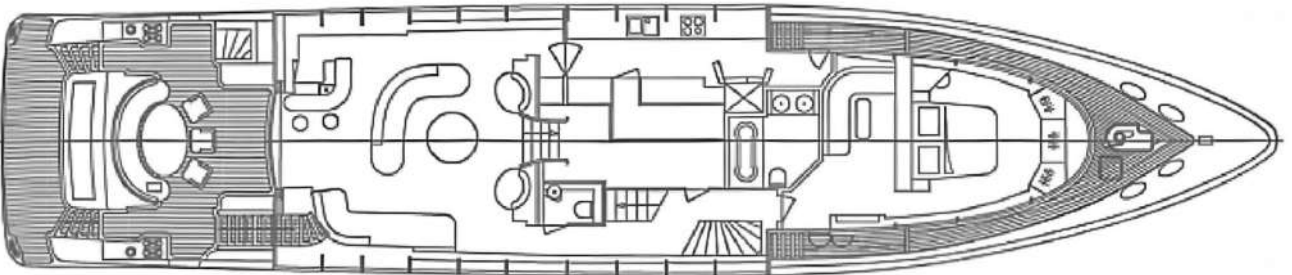
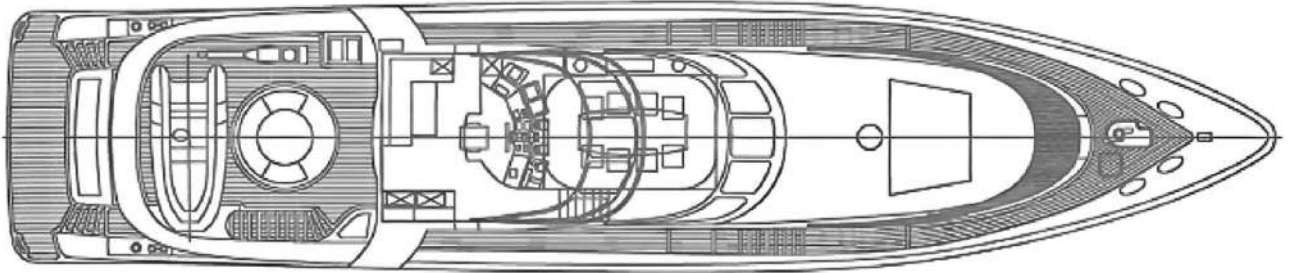



[For more information, CLICK HERE](#)



**EMMA KARANOVA**

Yacht Advisor

 WHATSAPP ME

m. +34 622 128 338

[emma@breezeyachting.swiss](mailto:emma@breezeyachting.swiss)

# breezeYachting.swiss

WE SPEAK YACHTING. LET'S TALK.

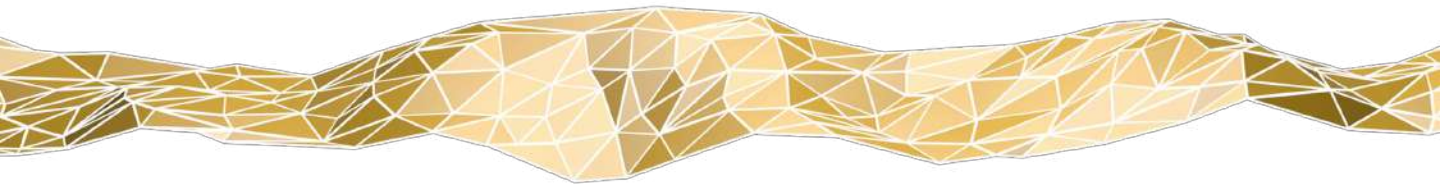

Switzerland ● Malta ● Spain ● Monaco

[www.breezeyachting.swiss](http://www.breezeyachting.swiss)

DISCLAIMER

The company offers the details of this vessel in good faith but cannot guarantee or warrant the accuracy of this information nor warrant the condition of the vessel. A buyer should instruct his agents, or his surveyors, to investigate such details as the buyer desires validated.

This vessel is offered subject to prior sale, price change or withdrawal without notice.